

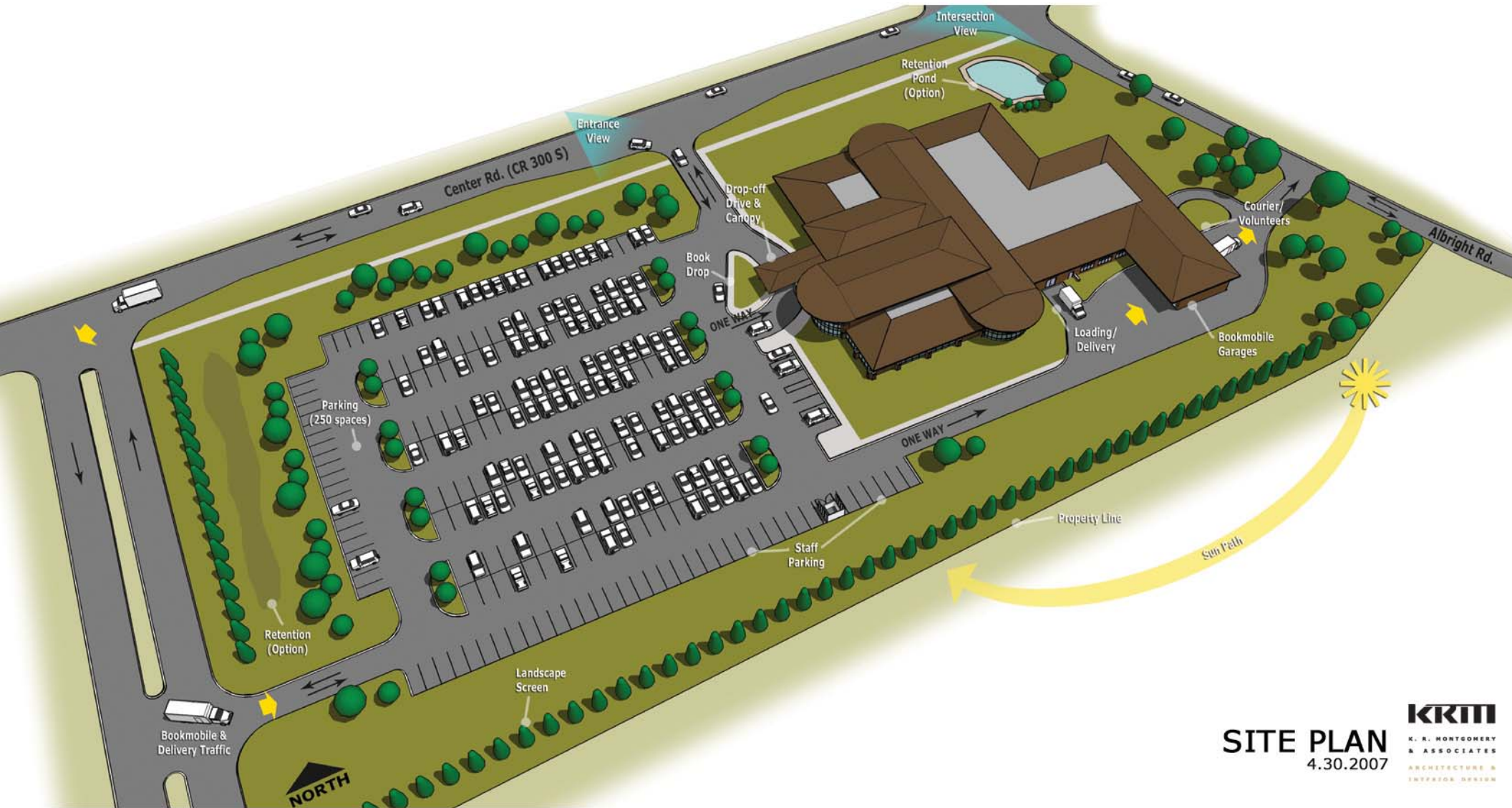

LIBRARY AT DUSK
4.30.2007

KRM
K. R. MONTGOMERY
& ASSOCIATES
ARCHITECTURE &
INTERIOR DESIGN



SITE PLAN
4.30.2007

KOKOMO-HOWARD COUNTY PUBLIC LIBRARY: SOUTH BRANCH ADDITION: SCHEMATIC DESIGN

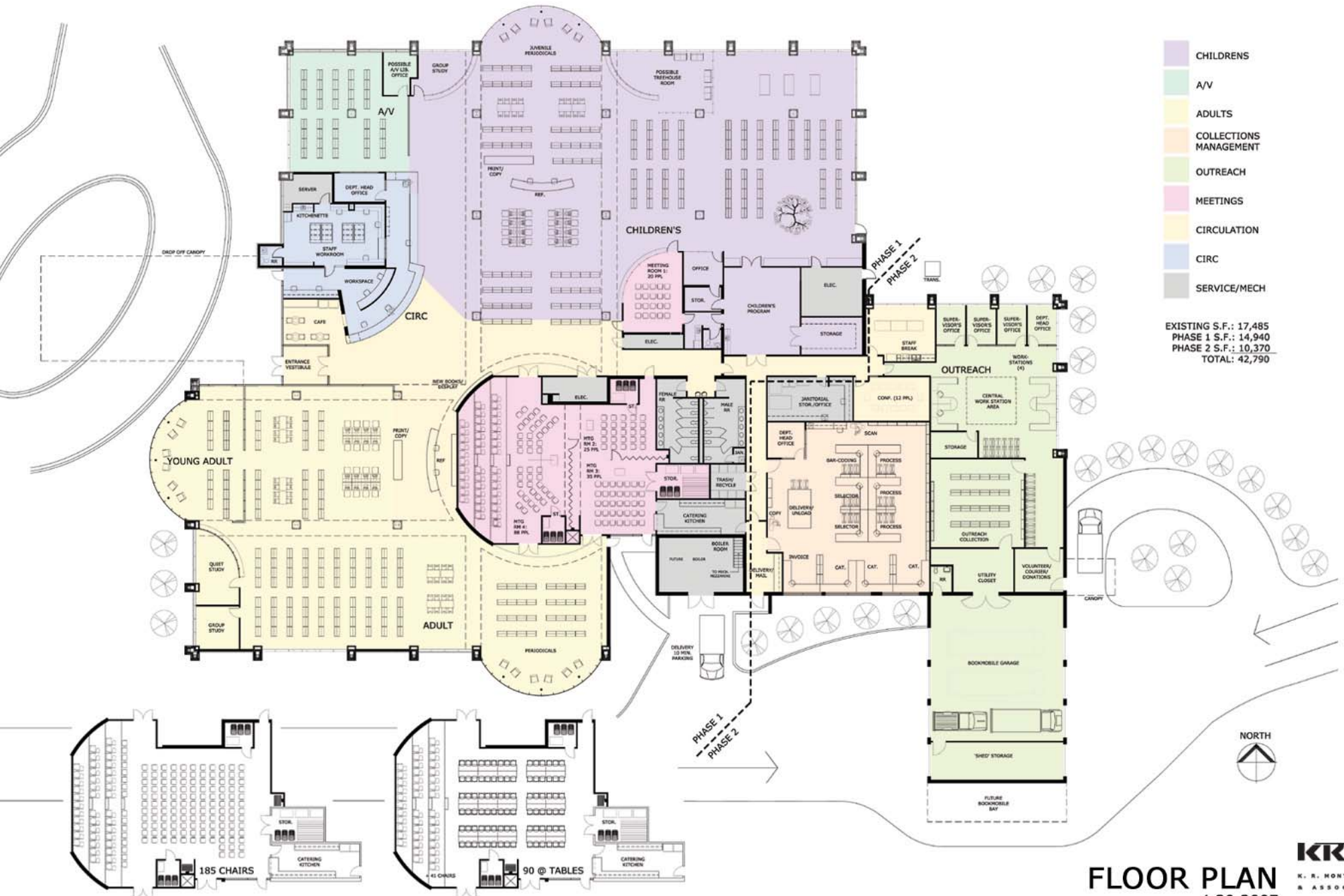

- CHILDRENS
- A/V
- ADULTS
- COLLECTIONS MANAGEMENT
- OUTREACH
- MEETINGS
- CIRCULATION
- CIRC
- SERVICE/MECH

EXISTING S.F.: 17,485
 PHASE 1 S.F.: 14,940
 PHASE 2 S.F.: 10,370
 TOTAL: 42,790

FLOOR PLAN
 4.30.2007